

ARTR151G10, ARTR151M10, ARTR151W10

15A Single Tamper-Resistant Outlet

Designed with the same commitment to style and safety as the entire adorne Collection, this device is ideal as a dedicated outlet for large or stationary appliances, or in small or narrow areas where a single plug is needed. The single outlet features “invisi-shutters” for discreet tamper-resistance that keeps children safe without compromising on style.

Available in Graphite, Magnesium or White.

Made exclusively for use with screwless Wall Plates from the adorne[®] Collection, sold separately.

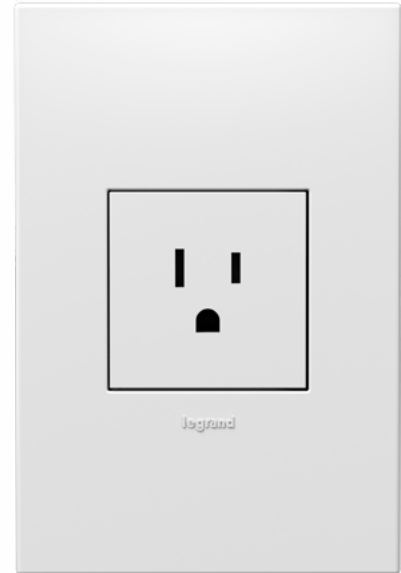

FEATURES & BENEFITS

Installs easily in place of any standard outlet in as little as 10 minutes

Available in three design-inspired colors to complement any style or décor

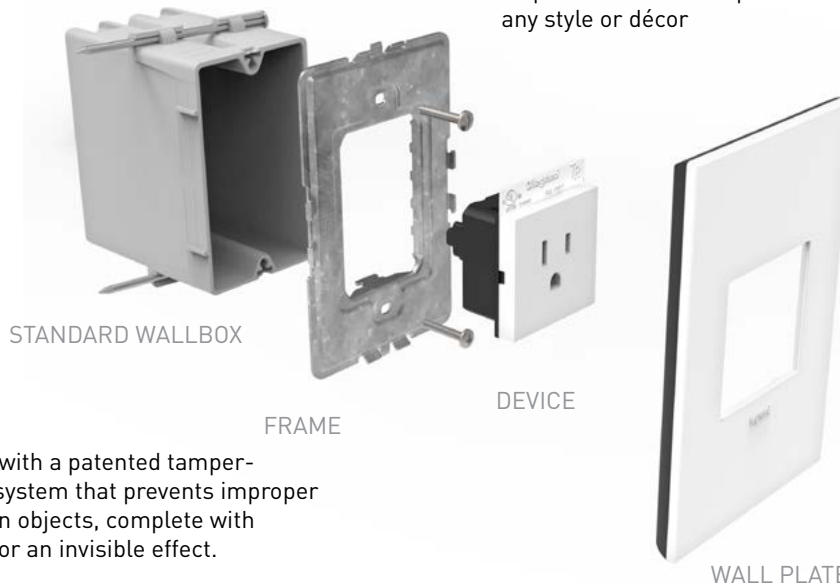

Creates a designated outlet, ideal for use with appliances or products and devices with larger plugs

Protects children with a patented tamper-resistant shutter system that prevents improper insertion of foreign objects, complete with “invisi-shutters” for an invisible effect.

Complete the look with a stunning, screwless adorne[®] Wall Plate (not included).

3rd Party Compliance



cULus Listed, UL508, Conforms to NEMA WD-1 and WD-6, File Number E140596.
Standard CSA C22.2 No. 42

ORDERING INFORMATION

CATALOG NUMBER	DESCRIPTION	RATING	NEMA	COMPLIANCE	COLORS	COO
ARTR151G10	2-Module Single Tamper-Resistant Outlet	15A, 125V	5-15R		Graphite	China
ARTR151W10	2-Module Single Tamper-Resistant Outlet	15A, 125V	5-15R		White	China
ARTR151M10	2-Module Single Tamper-Resistant Outlet	15A, 125V	5-15R		Magnesium	China

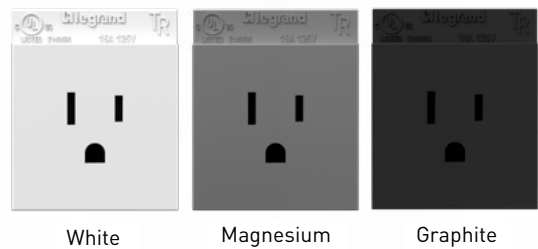

White

Magnesium

Graphite

VERTICAL MARKETS

- Residential
- Hospitality
- Luxury Office
- Light Commercial

COMPLEMENTARY PRODUCTS

adorne® also offers Paddle Style Dimmers and Fan Control Devices to pair with our Paddle Style Switches for an overall, aesthetically pleasing and multi-functional installation.

adorne® Wall Plates provide the perfect complement to adorne Switches, Dimmers, Outlets, and Accessories. The collection includes a variety of finishes, from metals to leather and wood, as well as plastic plates that are available in contemporary and classic colors.

Each wall plate is packaged with a metal frame to enable easy installation when paired with a device. All plates are screwless and simply snap onto the included metal frame.

All adorne wall plates are UL and ETL-approved.



2-Module Paddle Dimmer



2-Module Paddle Fan Speed Control



1-Module Paddle Switch

TECHNICAL SPECIFICATIONS

3rd Party Compliance

cULus Listed, File Number E140596, Standard UL498,

Performance

ELECTRICAL

Dielectric Voltage	Withstands 1500V minimum
Maximum Working Voltage	125VAC
Current Rated	15A interrupting at full-rated current
Temperature Rise	30°C Maximum at full-rated current

MECHANICAL

Back Wire	With internal pressure plates, #8-32 screw
Terminal Accommodations	#14AWG-#12AWG

ENVIRONMENTAL

Flammability	UL94 V2
--------------	---------

Materials

Face	Polycarbonate	Terminal	Brass
Back Body	Polycarbonate	Termination	Steel Plated Screws
Contacts	Silver		

Warranty

Limited Lifetime Warranty

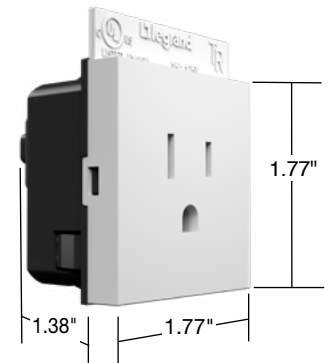
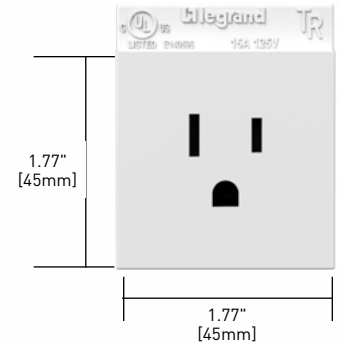

COMPLEMENTARY DEVICES & ACCESSORIES



sofTap™

Switches & Dimmers – designed with an innovative micro-movement that turns lights on and off with just a soft “tap” of the finger.



SensaSwitch™

Switches & Dimmers – Sensor turns lights on when you enter a room and off when you leave. (Also available in Manual-ON/Auto-OFF format.)



Whisper™

Switches & Dimmers – A smart design that features elegant lines and a quiet, fluid motion.



Touch™

Switches & Dimmers – A stunning translucent face works just like an iPhone® — simply touch your finger on the circle to turn lights on and off.

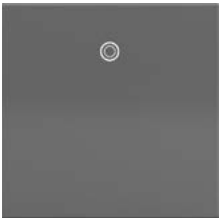

Paddle™

Switches, Dimmers & Fan Speed Controls – A wide, graceful curve works with a simple up-and-down motion, allowing you to turn lights on and off with ease.



Wave™

Switches – Smart technology combined with sleek, modern design. Simply wave your hand to turn lights on and off.



Push™

Switches – A tactile, finger-sized impression lets you turn lights on and off with a simple push-button motion.

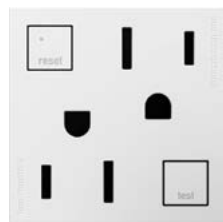

Tamper-Resistant Outlets/ Tamper-Resistant GFCI Outlets



USB Charging Outlets



Nightlight/Portable Nightlight Flashlight

PLUS: Compatible Wall Plates, Accent Lights, Locator Lights, Under-Cabinet Lighting System

NOTE: All brand and product names referenced in this document are registered trademarks or trademarks of their respective holders.



Legrand, North America
60 Woodlawn Street
West Hartford, CT 06110
1.877.BY.LEGRAND (295.3472)
www.legrand.us

Canada
905.738.9195
www.legrand.ca

