

SAMAR VL57532

WALL

PROJECT

DESCRIPTION

The stunning blown glass shades of the Samar Collection make wonderfully versatile statement pieces or subtle lighting options. The three ombre finishes are gorgeous specimens available in various hanging options that help create a dynamic space through lighting and tone. Each glass finish has three fixture finishes that help create an exciting piece for a unique space in your home.



VL57532-BG/CP
Brushed
Gold/Copper



VL57532-BK/SM
Black/Smoked



VL57532-CH/OP
Chrome/Opal Glass

SPECIFICATION DETAILS

| | |
|-------------------------------|---|
| Fixture Dimensions | W32-3/8" x H7-1/2" x E6" |
| Lamp Type | Incandescent, A15, Medium Base |
| Wattage | 3 x 60W |
| Voltage | 120V |
| Glass Details | Transition Copper Glass, Transition Smoked Glass or Transition Opal Glass |
| Location | Damp |
| Bulbs Included | No |
| Illumination Direction | Front |
| Mounting Style | All Orientation |
| Canopy Dimensions | L30 x H5-1/8" x E5/8" |
| Paint Finish | BG01; BK01; CH01; |

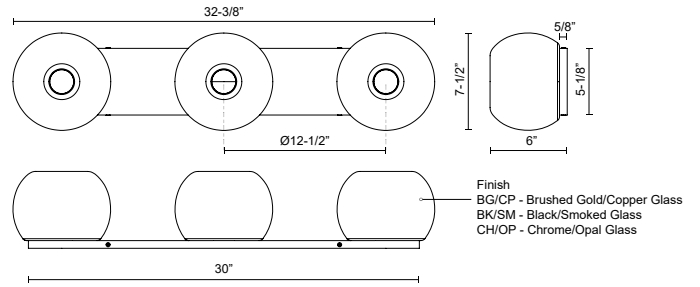

* For custom options, consult factory for details.

* For warranty information, please visit www.kuzcolighting.com/warranty

KUZCO

CANADA: 19054 28TH AVENUE - SURREY, BC V3Z 6M3

USA: 3035 E. LONE MOUNTAIN ROAD - LAS VEGAS, NV 89081

WWW.KUZCOLIGHTING.COM

© 2023 KUZCO LIGHTING. ALL RIGHTS RESERVED.

COMMENT

