

**NOLA**  
**SF57704**  
 SEMI FLUSH

PROJECT



SF57704-BK  
 Black

SF57704-BK/GO  
 Black/Glossy Opal  
 Glass

**SPECIFICATION DETAILS**

<b>Fixture Dimensions</b>	D3-5/8" x H7-1/2"
<b>Lamp Type</b>	Incandescent, A19, Medium Base
<b>Wattage</b>	1 x 40W
<b>Voltage</b>	120V
<b>Shade Details</b>	Steel Shade
<b>Glass Details</b>	Opal Glass
<b>Location</b>	Dry
<b>Bulbs Included</b>	No
<b>Illumination Direction</b>	BK-Down; BK/GO-Omni-directional;
<b>Canopy Dimensions</b>	D5-5/8" x H7/8"
<b>Material</b>	Steel; Steel + Glass;
<b>Paint Finish</b>	BK02; WH01;

\* For custom options, consult factory for details.  
 \* For warranty information, please visit [www.kuzcolighting.com/warranty](http://www.kuzcolighting.com/warranty)

**DESCRIPTION**

Meet Nola, where modern design meets accessibility in a stunning array of fixtures. This versatile family boasts a sleek, socket-based design, marrying the elegance of domed metal or Glossy Opal glass cylindrical shades with the allure of exposed bulbs. Nola's simple, timeless shapes effortlessly elevate any space, from a gracefully balanced chandelier to a single, focused downlight. Whether you're looking to make a statement or create an inviting ambiance, Nola offers the perfect blend of style and functionality.

- Simple, classic shape
- Matte Black Finish
- Matte Black Metal or Glossy Opal Glass shades
- Recommended bulb A19, Medium Base

**Black/ Glossy Opal Glass Finish**

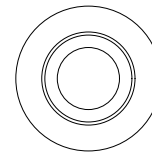
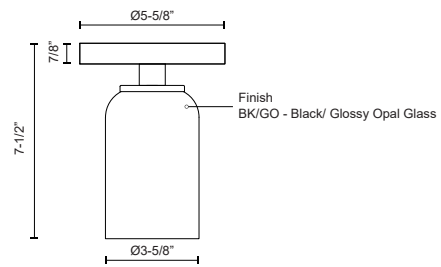

**Black Finish**

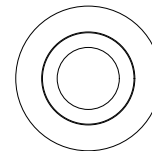
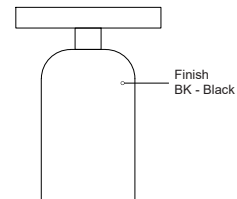

**COMMENT**

**KUZCO**

CANADA: 19054 28TH AVENUE - SURREY, BC V3Z 6M3  
 USA: 3035 E. LONE MOUNTAIN ROAD - LAS VEGAS, NV 89081

[WWW.KUZCOLIGHTING.COM](http://WWW.KUZCOLIGHTING.COM)

© 2024 KUZCO LIGHTING. ALL RIGHTS RESERVED.

