

# AETHER 2" - Square Wall Wash Trim

## R2ASWT



Fixture Type:

Catalog Number:

Project: \_\_\_\_\_

Location: \_\_\_\_\_

### PRODUCT DESCRIPTION

Shallow housing that is designed to fit in tight plenum spaces without sacrificing lumen output.

### FEATURES

- Designed to fit in tight plenum
- Wet location listed for trims
- 2" trim aperture, 2" housing height
- Universal input voltage (120V-277V)
- 5 year WAC Lighting product warranty

### SPECIFICATIONS

- Construction:** Die-cast aluminum trim with die-cast aluminum heat sink
- Dimming:** 100% - 5% with 0-10V  
100% - 5% with Electronic Low Voltage (ELV)/ TRIAC
- Input:** 120V-277V AC
- Power:** 15W, power factor 0.9
- Mounting:** Retention clips firmly hold trim to housing
- Finish:** Powder Coated White, Black/White, Haze/White, Black
- Ceiling thickness:** ½" - 1"
- Standards:** UL & cUL Wet Location Listed, Title 24  
JA8 Compliant

Trim (See next page for housing)	Model	Beam	Color Temp	CRI	Lumens	Finishes
	<b>R2ASWT</b> Square, Wall Wash Lensed, Wet Location	<b>A</b> Asymmetrical	<b>827</b> 2700K 85 1000	85	1060	<b>BK</b> Black <b>BKWT</b> Black/White <b>HZWT</b> Haze/White <b>WT</b> Whitew
			<b>830</b> 3000K			
			<b>835</b> 3500K			
			<b>840</b> 4000K			
			<b>927</b> 2700K 90 830	90	865	
			<b>930</b> 3000K			

**R2ASWT-\_\_\_\_\_ - \_\_\_\_\_**

Example: **R2ASWT-A930-WT**

Please see next page for housing (required)

wacighting.com

Phone (800) 526.2588

Fax (800) 526.2585

Headquarters, East Manufacturing Facility

44 Harbor Park Drive

Port Washington, NY 11050

South East Manufacturing Facility

1600 Distribution Ct

Lithia Springs, GA 30122

Central Manufacturing Facility

1700 South J Elmer Freeway, Ste 100

Cedar Hill, TX 75104

West Manufacturing Facility

1750 S Archibald Ave

Ontario, CA 91761

# AETHER

## HR-2LED-H13A - Housing



Housing

Model

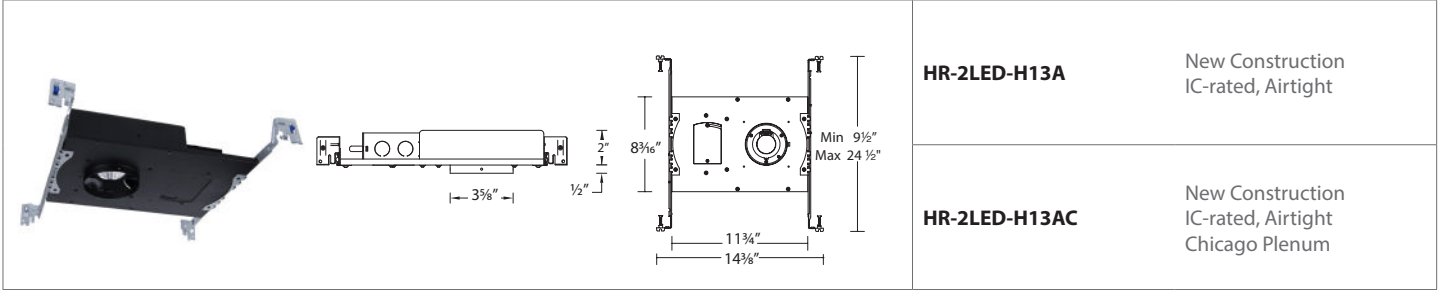

**HR-2LED-H13A**

New Construction  
IC-rated, Airtight

**HR-2LED-H13AC**

New Construction  
IC-rated, Airtight  
Chicago Plenum

### HR-2LED-H13

Example: HR-2LED-H13A

wacighting.com

Phone (800) 526.2588

Fax (800) 526.2585

**Headquarters, East Manufacturing Facility**

44 Harbor Park Drive

Port Washington, NY 11050

**South East Manufacturing Facility**

1600 Distribution Ct

Lithia Springs, GA 30122

**Central Manufacturing Facility**

1700 South J Elmer Freeway, Ste 100

Cedar Hill, TX 75104

**West Manufacturing Facility**

1750 S Archibald Ave

Ontario, CA 91761