

AETHER 2" - Square Wall Wash Trimless

R2ASWL



Fixture Type:

Catalog Number:

Project: _____

Location: _____

PRODUCT DESCRIPTION

Shallow housing that is designed to fit in tight plenum spaces without sacrificing lumen output.

FEATURES

- Designed to fit in tight plenum
- Wet location listed for trims
- 2" trim aperture, 2" housing height
- Universal input voltage (120V-277V)
- 5 year WAC Lighting product warranty

SPECIFICATIONS

- Construction:** Die-cast aluminum trim with die-cast aluminum heat sink
- Dimming:** 100% - 5% with 0-10V
100% - 5% with Electronic Low Voltage (ELV)/ TRIAC
- Input:** 120V-277V AC
- Power:** 15W, power factor 0.9
- Mounting:** Retention clips firmly hold trim to housing
- Finish:** Powder Coated White, Black, Black/White, Haze/White
- Ceiling thickness:** 1/2" - 1"
- Standards:** UL & cUL Wet Location Listed, Title 24 JA8 Compliant

Trim (See next page for housing)	Model	Beam	Color Temp	CRI	Lumens	Finishes
	R2ASWL Square, Wall Wash Lensed, Wet Location	A Asymmetrical	827 2700K	85	1000	BK Black BKWT Black/White HZWT Haze/White WT White
			830 3000K	85	1060	
			835 3500K	85	1085	
			840 4000K	85	1095	
			927 2700K	90	830	
			930 3000K	90	865	

R2ASWL- _____ **-** _____

Example: **R2ASWL-A930-WT**

Please see next page for housing (required)

AETHER

HR-2LED-H13A - Housing



Housing

Model

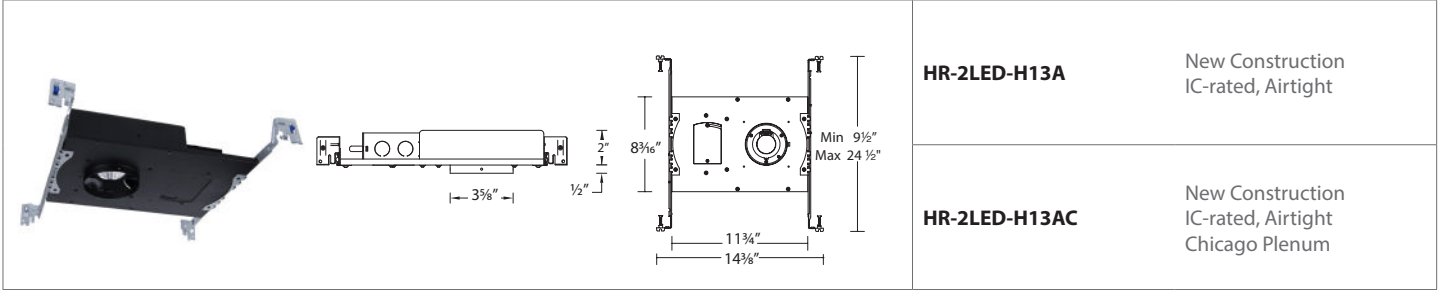

HR-2LED-H13A

New Construction
IC-rated, Airtight

HR-2LED-H13AC

New Construction
IC-rated, Airtight
Chicago Plenum

HR-2LED-H13 _____

Example: **HR-2LED-H13A**

wacighting.com

Phone (800) 526.2588

Fax (800) 526.2585

Headquarters, East Manufacturing Facility

44 Harbor Park Drive

Port Washington, NY 11050

South East Manufacturing Facility

1600 Distribution Ct

Lithia Springs, GA 30122

Central Manufacturing Facility

1700 South J Elmer Freeway, Ste 100

Cedar Hill, TX 75104

West Manufacturing Facility

1750 S Archibald Ave

Ontario, CA 91761