

AETHER 2"

R2ASAL - Square Adjustable Trimless

WAC®

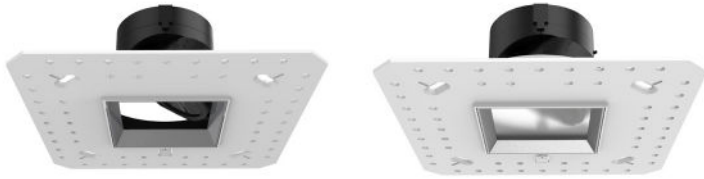

Fixture Type:

Catalog Number:

Project: _____

Location: _____

PRODUCT DESCRIPTION

Shallow housing that is designed to fit in tight plenum spaces without sacrificing lumen output.

FEATURES

- Designed to fit in tight plenum
- 2" trim aperture, 2" housing height
- Damp Location Trims: 0-30° vertical and 365° horizontal adjustment
- Wet Location Trims: 0-25° vertical and 365° horizontal adjustment
- 5 year WAC Lighting product warranty

SPECIFICATIONS

- Construction:** Die-cast aluminum trim with die-cast aluminum heat sink
- Dimming:** 100% - 5% with 0-10V
100% - 5% with Electronic Low Voltage (ELV)/ TRIAC
- Input:** 120V-277V AC
- Power:** 15W, power factor 0.9
- Mounting:** Retention clips firmly hold trim to housing
- Finish:** Powder Coated White, Black, Enamel Coated Haze
- Ceiling thickness:** ½" - 1"
- Standards:** UL & cUL Damp Listed, UL & cUL Wet Listed (Lensed options only), Title 24 JA8 Compliant

| Trim (See next page for housing) | Model | Beam | Color Temp | CRI | Lumens | CBCP | Finishes |
|---|---|-------------------------------|--|---|--|--|----------|
| | R2ASAL Square, 0-30° Adjustable Damp Location | N 26° | 827 2700K 85 1275 4270 | 830 3000K 85 1355 4530 835 3500K 85 1385 4640 840 4000K 85 1395 4675 | 927 2700K 90 1055 3535 930 3000K 90 1100 3685 | HZ Haze WT White BK Black | |
| | | | 927 2700K 90 1055 3535 | | | | |
| | | | 930 3000K 90 1100 3685 | | | | |
| | | | 827 2700K 85 1280 2530 | | | | |
| | | | 830 3000K 85 1355 2685 | | | | |
| | | | 835 3500K 85 1390 2750 | | | | |
| | 840 4000K 85 1400 2770 | | | | | | |
| | R2ASAL Square, 0-25° Adjustable Lensed, Wet Location | F 40° | 927 2700K 90 1060 2095 | 930 3000K 90 1100 2180 | HZ Haze WT White BK Black | | |
| | | | 827 2700K 85 1180 3680 | | | | |
| | | | 830 3000K 85 1250 3905 | | | | |
| | | | 835 3500K 85 1280 4000 | | | | |
| | | | 840 4000K 85 1290 4030 | | | | |
| 927 2700K 90 975 3045 | | | | | | | |
| R2ASAL Square, 0-25° Adjustable Lensed, Wet Location | N 28° | 930 3000K 90 1015 3175 | LHZ Lensed Haze LWT Lensed White LBK Lensed Black | | | | |
| | | 827 2700K 85 1175 2245 | | | | | |
| | | 830 3000K 85 1245 2380 | | | | | |
| | | 835 3500K 85 1275 2435 | | | | | |
| | | 840 4000K 85 1285 2455 | | | | | |
| | | 927 2700K 90 975 1855 | | | | | |
| R2ASAL Square, 0-25° Adjustable Lensed, Wet Location | F 40° | 930 3000K 90 1015 1935 | LHZ Lensed Haze LWT Lensed White LBK Lensed Black | | | | |
| | | 827 2700K 85 1175 2245 | | | | | |
| | | 830 3000K 85 1245 2380 | | | | | |
| | | 835 3500K 85 1275 2435 | | | | | |
| | | 840 4000K 85 1285 2455 | | | | | |
| | | 927 2700K 90 975 1855 | | | | | |

R2ASAL-_____ - _____

Example: **R2ASAL-N930-WT**

Please see next page for housing (required)

AETHER

HR-2LED-H13A - Housing



Housing

Model

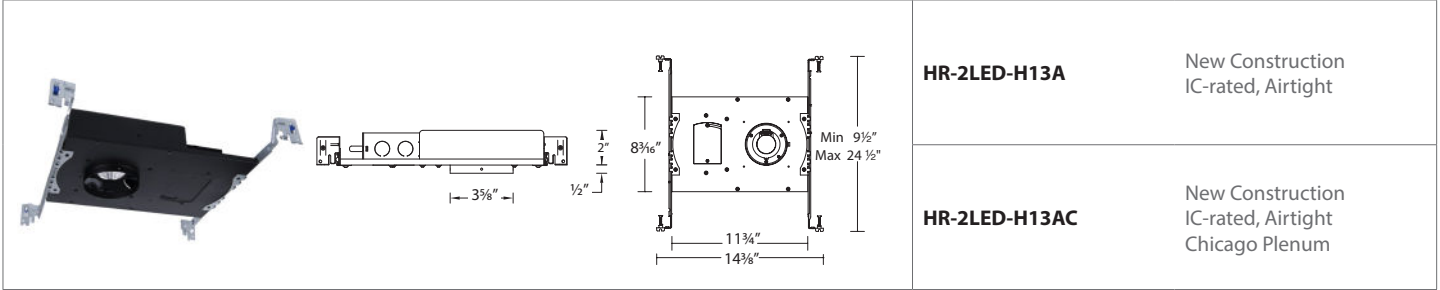

HR-2LED-H13A

New Construction
IC-rated, Airtight

HR-2LED-H13AC

New Construction
IC-rated, Airtight
Chicago Plenum

HR-2LED-H13 _____

Example: **HR-2LED-H13A**

wacighting.com

Phone (800) 526.2588

Fax (800) 526.2585

Headquarters, East Manufacturing Facility

44 Harbor Park Drive

Port Washington, NY 11050

South East Manufacturing Facility

1600 Distribution Ct

Lithia Springs, GA 30122

Central Manufacturing Facility

1700 South J Elmer Freeway, Ste 100

Cedar Hill, TX 75104

West Manufacturing Facility

1750 S Archibald Ave

Ontario, CA 91761