

QUESTIONS OR CONCERNS CONTACT CANARM AT:

1-800-265-1833 (English) / 1-800-567-2513 (French)  
Monday through Friday 8:00 AM to 5:00 PM E.S.T.



"INSTRUCTIONS PERTAINING TO RISK OF FIRE OR INJURY TO PERSONS"  
"READ ALL INSTRUCTIONS"

**"IMPORTANT SAFETY  
INSTRUCTIONS"**  
**"SAVE THESE INSTRUCTIONS"**

## TOOLS AND MATERIALS REQUIRED:



Blade  
Screwdriver



Wire Cutters

Wiring supplies  
as required by  
the Canadian  
Electrical Code  
and/or the  
Quebec  
Electrical code

## SAFETY PRECAUTIONS:

1. TURN OFF ELECTRICAL POWER BEFORE STARTING INSTALLATION OF LIGHT FIXTURE.
2. THIS PRODUCT MUST BE INSTALLED IN ACCORDANCE WITH THE APPLICABLE INSTALLATION CODE BY A PERSON FAMILIAR WITH THE CONSTRUCTION AND OPERATION OF THE PRODUCT AND THE HAZARDS INVOLVED.
3. CONNECT THE HOUSEHOLD SUPPLY GROUND WIRE (BARE COPPER OR GREEN) TO THE GROUND WIRE (GREEN) INSERT FROM THE FIXTURE.

## INSTALLATION:

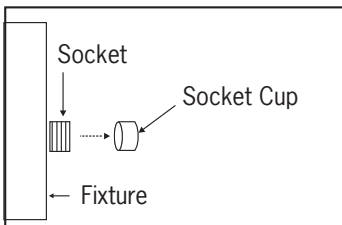

1. Remove the socket cup.

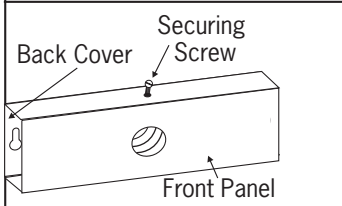

2. Loosen the screw on the front panel.

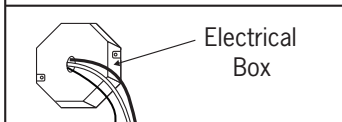

3. Feed power cords from the outlet box through the centre hole of the back cover. Align holes of back cover over outlet box and secure with outlet box screws (not included).

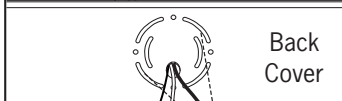

4. Additional support may be required for fixtures longer than 20". Position the fixture and add wood screws (one on each side) for the wooden studs or plastic wall anchor and wood screws for dry wall.



5. Connect house wires

Insert electrical supply cable through knock-out in the junction box.

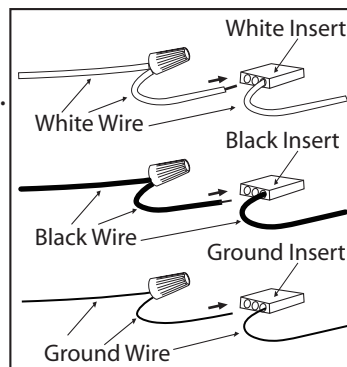

For Multiple Electrical Box Wires

For multiple black (live) & white (neutral) wires joined in the electrical box (house wiring), attach a single "black" and "white" Jumper Wire before connecting. Strip 7mm from a 6" Jumper Wires (AWG 12-24) supplied. Then connect (push) wires into correct inserts.

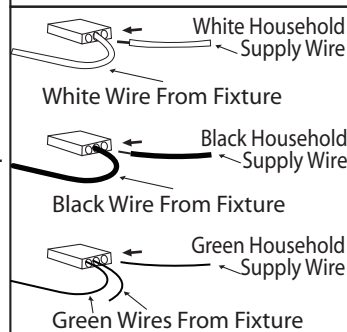

6. Connect light fixture wires

Connect (push) electrical wires from fixture into correct inserts. Black (live), White (neutral), Green (ground)

**ENSURE NO BARE COPPER WIRE IS EXPOSED AFTER INSERTION ON THE BLACK AND WHITE WIRE INSERT. ENSURE THE GROUND WIRE ON THE BACK COVER IS INSERTED TO THE GROUND INSERT.**

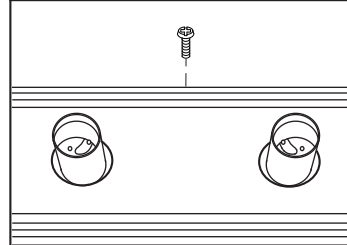

7. To secure back cover to the front panel, insert and tighten the securing screw at the top of the fixture.

8. Push and twist socket cups onto socket. Install the proper bulb type and wattage (not included).