



Product Features

1. 270° Wide Beam Angle.
2. Built-in motion / daylight sensor with remote.
3. UL924 qualified build-in 3H battery backup.
4. IP 65 and UL, CUL, CE, RoSH, FCC etc certified.

ENQUIRY

Parameter

Dimension

Installation

Wiring

Application

Model No	Power (W)	Voltage (V)	CCT (K)	Lumens (LM)	CRI	Power factor	Beam angle	SDCM	DIM	Certification
TP-20W-0.6M	20	100~277/100~240	3000-6500	2400	>82	>0.95	270°	≤5	Y	DLC,UL,CE,RoHS
TP-36W-1.2M	36	100~277/100~240	3000-6500	4320	>82	>0.95	270°	≤5	Y	DLC,UL,CE,RoHS
TP-45W-1.2M	45	100~277/100~240	3000-6500	5400	>82	>0.95	270°	≤5	Y	DLC,UL,CE,RoHS
TP-60W-1.5M	60	100~277/100~240	3000-6500	7200	>82	>0.95	270°	≤5	Y	DLC,UL,CE,RoHS
TP-60W-2.4M	60	100~277/100~240	3000-6500	7200	>82	>0.95	270°	≤5	Y	DLC,UL,CE,RoHS
TP-70W-2.4M	70	100~277/100~240	3000-6500	8400	>82	>0.95	270°	≤5	Y	DLC,UL,CE,RoHS

Dimension



ModelNo.	L1(mm)			L2(mm)			W(mm)			H(mm)		
	A	B	C	A	B	C	A	B	C	A	B	C
TP-2FT-20W	600	650	600	540			94			60		
TP-3FT-25W	900	950	900	840			94			60		
TP-4FT-36W	1200	1250	1200	1140			94			60		
TP-4FT-45W	1200	1250	1200	1140			94			60		
TP-5FT-60W	1500	1550	1500	1440			94			60		
TP-8FT-70W	2400	2450	2400	2340			94			60		

Installation

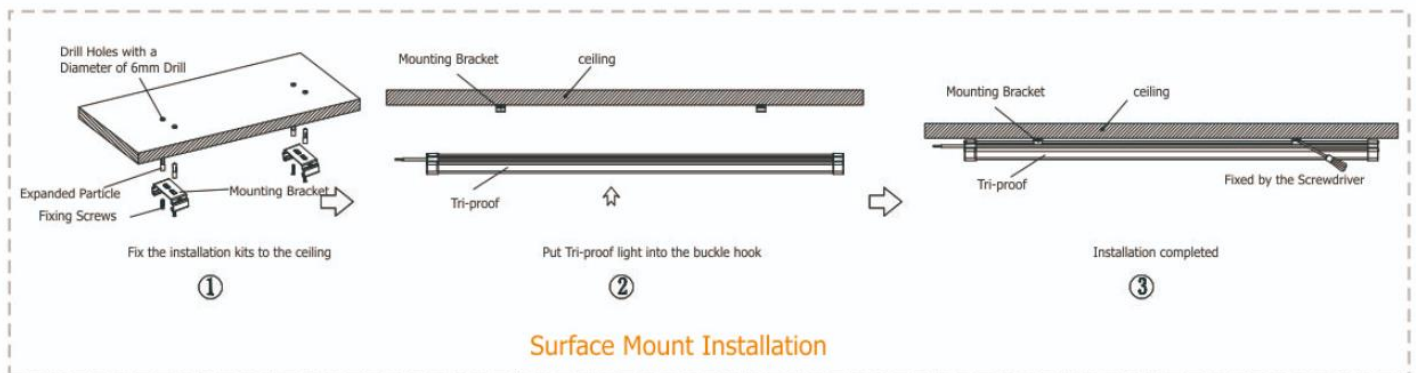
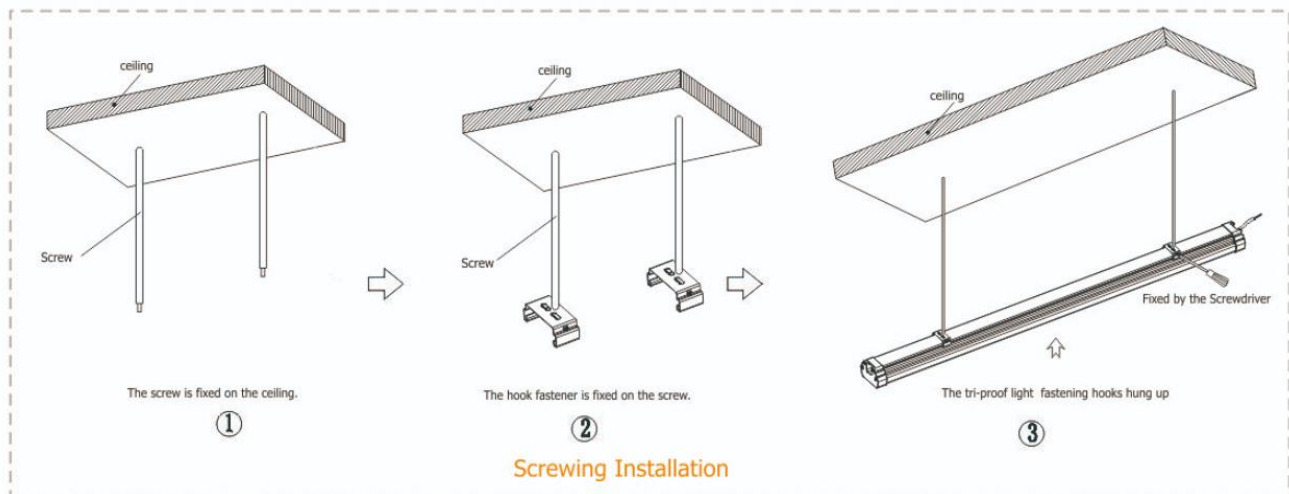
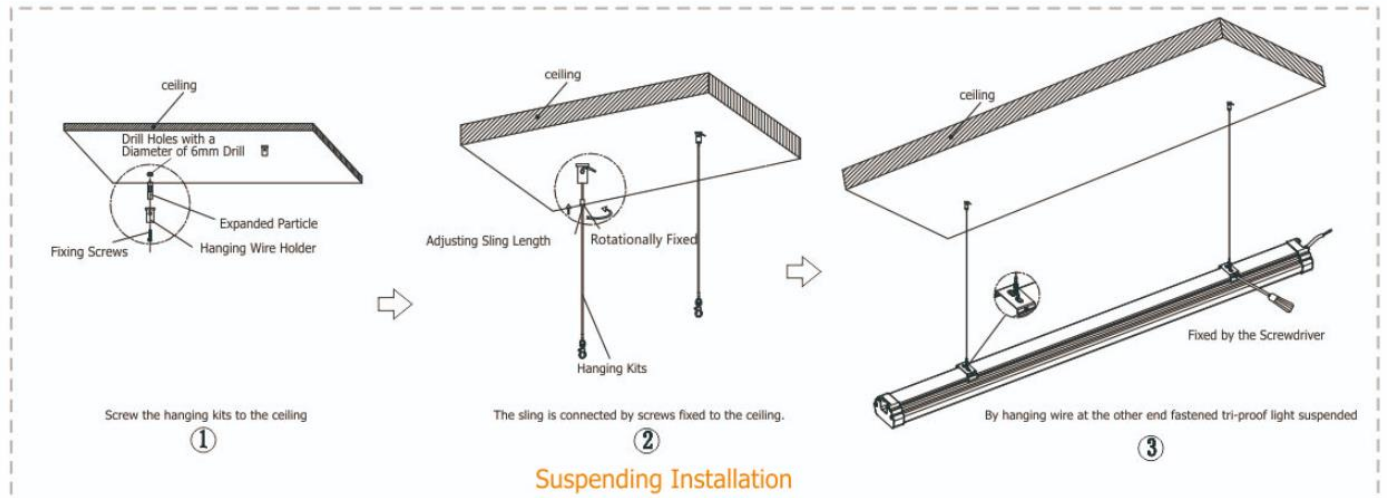

B: Parallel /series connection without input lines.

90V-305V

For emergency only
L
N

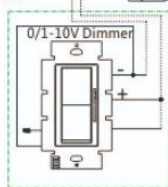

If non-dim lamps, no need reference to the dashed part.

LED1

LED2

LED...N

Bare wire/ PVC pipe. Waterproof
(use PG9 connection hole)

Remark: Please check the maximal power of product internal wiring as follow
(use minimum #18 line for external wiring):

- Input 120v, total power of connection in series dont exceed 400W.
- Input 230v, total power of connection in series dont exceed 800W.
- Input 277v, total power of connection in series dont exceed 1000W.

PG9 waterproof
connection hole.φ16mm



PG9 connector

Series connection/Linkable (Picture 1)

Metal Hose connection hole.φ22mm.

90V-305V

For emergency only
L
N

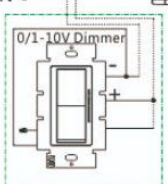

If non-dim lamps, no need reference to the dashed part.

LED1

LED2

LED...N

Metal Hose connection,
non-waterproof

Remark: Please check the maximal power of product internal wiring as follow
(use minimum #18 line for external wiring):

- Input 120v, total power of connection in series dont exceed 400W.
- Input 230v, total power of connection in series dont exceed 800W.
- Input 277v, total power of connection in series dont exceed 1000W.



Metal Hose

Series connection/Linkable (Picture 2)

90V-305V

For emergency only
L
N

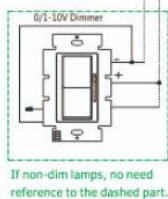

If non-dim lamps, no need reference to the dashed part.

LED1

LED2

LED...N

PG9 connector
Waterproof

Metal Hose connection
hole.φ22mm.

PG9 waterproof
connection hole.φ16mm

90V-305V

For emergency only
L
N

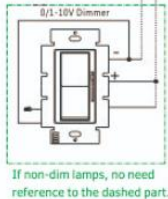

If non-dim lamps, no need reference to the dashed part.

LED1

LED2

LED...N

Metal Hose connection
non-waterproof

The quantity of parallel connection according to the electric current of 'L\N' trunk.

Parallel connection (Picture 1)

Parallel connection (Picture 2)



PG9 connector



Metal Hose

Three connection modes optional.

A: Parallel connection with input lines (Length of lines can be customized). Usually used projects have confirmed length of input lines.

B: Parallel /series connection without input lines. Users can prepare any length of the input/output lines as per project requirements. And can use Metal Hose.
Very flexible and good for stock.

C: Seamless connection. Suitable for shopping mall,supermarket and other places that need series connection without any space between two lamps.

A: Parallel connection with input lines(Length of lines can be customized).

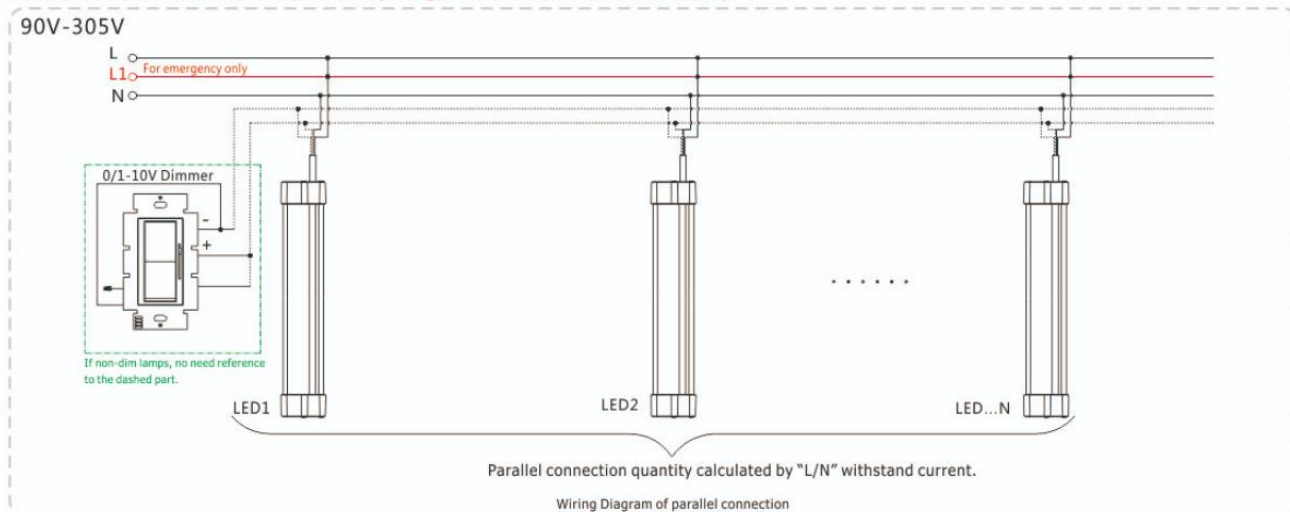

Application

Parking Lot, Subway ,Large Supermarket, Food Processing Factory ,Animal & plant Farm ,School &Hospital, Gas Station MTR Station, Airport ,Office indoor lighting.

