

Introduction

- For retrofit or new construction installation
- Universal housing compatibility
- Adjustable lumen output and Color – 3 defined light levels,
- Easy fit installation – Spring-action housing clips
- Universal voltage 110-277V,0-10V Dimming

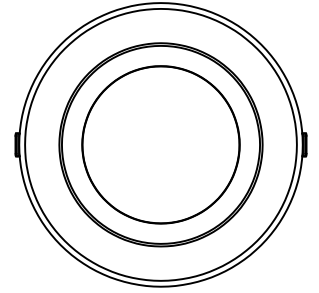

ORDERING INFORMATION

Adjustable Lumen Output and Color

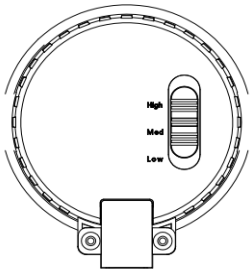

Model	PRODUCT FEATURES		
D8463	Power	Lumens	Color
	LOW-10W	900	3000
	MED-15W	1350	4000
	HIGH-22W	2000	5000

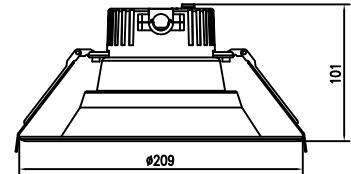

This commercial downlight features adjustable lumen output for three distinct lumen levels equivalent to various CFL lamp combinations. Simply adjust the lamp power or color to the desired lumen output by sliding the selector switch on top of the fixture.

Easy-Fit Installation

The adjustable housing clips allow for installation in a large range of commercial and architectural housings ranging from 6.0"-7.4" (153-190mm). These spring-action clips push up easily and fit securely for both retrofit and new construction installations.

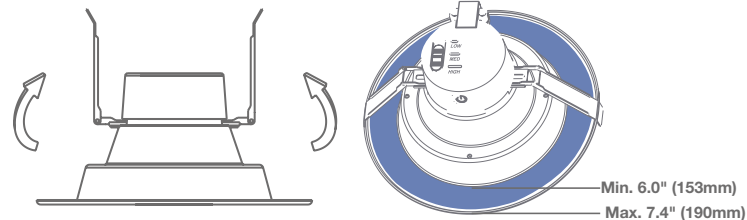

Electrical Data

SIMPLE RETROFIT OR ECONOMICAL NEW CONSTRUCTION INSTALLATION

Retrofit Installation

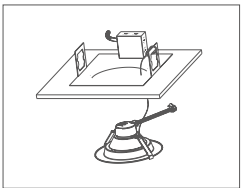

Attach safety clip

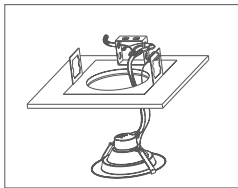

Bypass ballast & wire to j-box



Adjust lumens or color to desired output

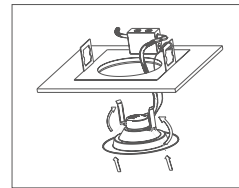

Push clips up & install into fixture

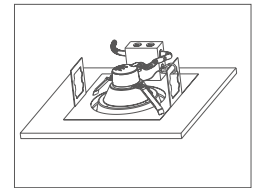

Ensure fixture is flush. Installation is complete

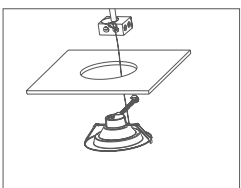

Attach safety clip

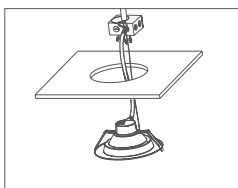

Wire to j-box

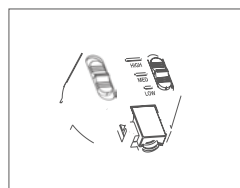

Adjust lumens or color to desired output

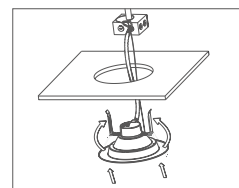

Push clips up & install into opening

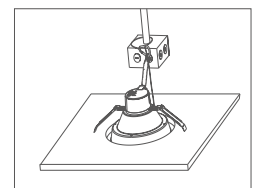

Ensure fixture is flush. Installation is complete

WARRANTY

- Five year limited warranty is standard on luminaire and components .