

BUTE WS8332

WALL

PROJECT



WS8332-BN
Brushed Nickel



WS8332-CH
Chrome



WS8332-BK
Black

SPECIFICATION DETAILS

* For custom options, consult factory for details.

Fixture Dimensions	W2" x H32" x E2-3/4"
Light Source	LED
Wattage	39W
Total Lumens	3200lm
Delivered Lumens	CH-2404lm
Voltage	120V
Color Temperature	3000K
CRI (Ra)	>90
Optional Color Temps	2700K - 5000K Available, Minimum Order Quantities Apply
LED Rated Life	50,000 hours
Dimming	100% - 10%, ELV Dimmer (Not Included)
Glass Details	White Opal Glass
Location	Dry
Warranty	5 Years
ADA Compliant	Yes
Canopy Dimensions	D4-3/4" x E3/8"

DESCRIPTION

Single LED wall sconce with cylinder shaped white opal glass. Metal details in brushed nickel or chrome finish, and is equipped with our powerful 120V AC LED technology.

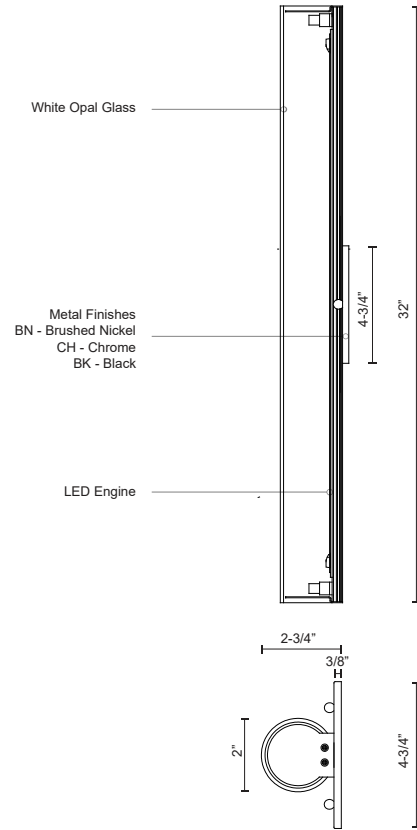

KUZCO

19054 28TH AVENUE
SURREY - BC V3Z 6M3
CANADA

WWW.KUZCOLIGHTING.COM

COMMENT

