

LED Table Lamp

TL25517
INSTALLATION SHEET

START FROM HERE

- Prepare everything in a clear area
- Wear gloves at all time during this installation
- Read instructions carefully before you start assembly
- Keep this installation sheet for future reference

Please Note:

- This Kuzco LED fixtures come with pre-wired LED module(s)
- Unless instructed, Do Not touch any part of the LED module(s) as any unnecessary contact with the module could cause permanent damage
- Touch Dimmer

Technical Support: 1-855-855-8926

1. Remove fixture from its original package
2. Plug lamp head (1a) into socket (1b), lock with screw (1c)
3. Plug upper section (2a) into base (2b), lock with screw (2c)
4. Plug port (3a) into base (2b)
5. Plug driver (3e) into outlet
6. Use touch switch (4a) to choose brightness setting

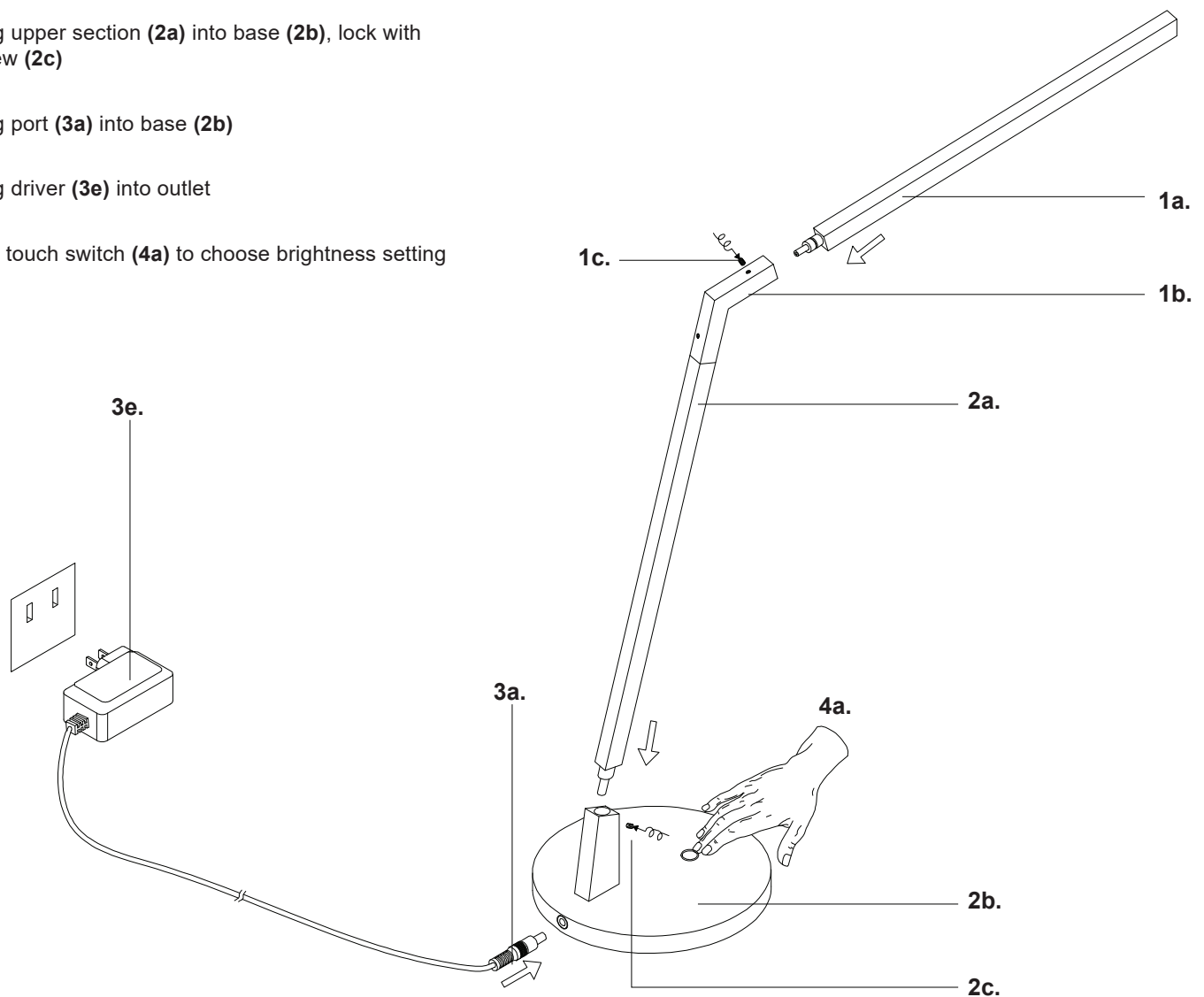

KUZCO

19054 28th Avenue Surrey, BC Canada V3Z 6M3
T: 604 538 7162 TF: 1-855 85 KUZCO F: 604 538 7196
W: kuzcolighting.com
20190618